

# 35849A-3

---

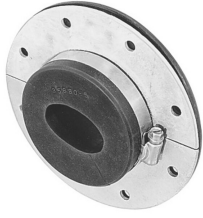

## Single Entrance Panel for elliptical waveguide 85

### Product Classification

**Product Type** Entrance panel

### General Specifications

**Color** Gray  
**Entry Panel Port Size** 127 mm | 5 in  
**Number of Ports** 1  
**Panel Type** Single

### Dimensions

**Height** 50.8 mm | 2 in  
**Width** 127 mm | 5 in  
**Waveguide Size** WR90 | WG16 | R100

### Material Specifications

**Material Type** Galvanized steel

### Environmental Specifications

**Weather Resistance Test Method** 04AS00-03.9.0 | IEC 60529.14.2

### Packaging and Weights

**Height, packed** 139.7 mm | 5.5 in  
**Width, packed** 139.7 mm | 5.5 in  
**Length, packed** 152.4 mm | 6 in  
**Included** Boot | Clamp | Plate  
**Packaging quantity** 1  
**Weight, gross** 0.5 kg | 1.102 lb

# 35849A-3

---

## Regulatory Compliance/Certifications

<b>Agency</b>	<b>Classification</b>
CHINA-ROHS	Below maximum concentration value
ISO 9001:2015	Designed, manufactured and/or distributed under this quality management system
REACH-SVHC	Compliant as per SVHC revision on <a href="http://www.andrew.com/ProductCompliance">www.andrew.com/ProductCompliance</a>
ROHS	Compliant
UK-ROHS	Compliant

