

| MATERIAL ID | DESCRIPTION |
|-------------|--|
| 760227637 | M11FR-262 SHUTTERED FACEPLATE, 1-PORT, WHITE |

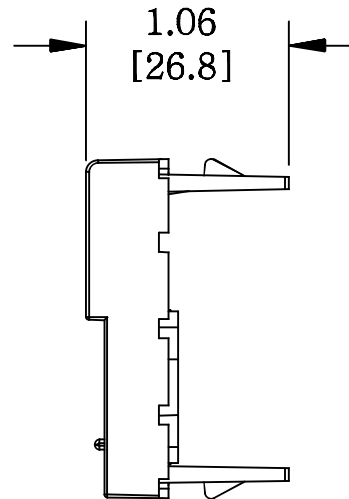
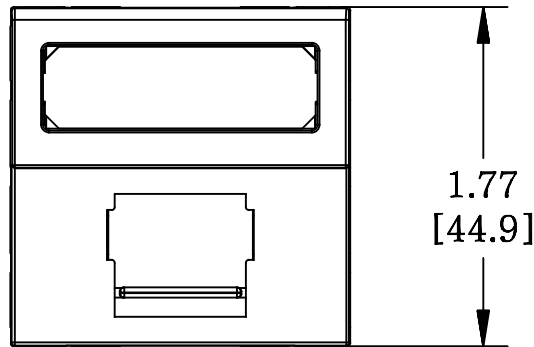
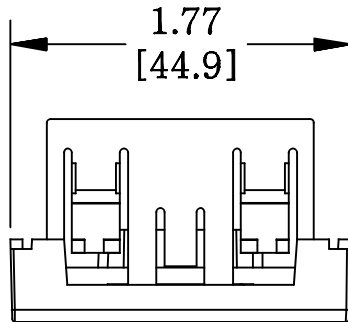

NOTES:

1. SEE COMMSCOPE CATALOG FOR PART NUMBER SUFFIXES TO INDICATE COLOR/PKG.
2. SEE COMMSCOPE CATALOG FOR COMPLETE LIST OF PARTS RELATED TO THE USE OF THIS PRODUCT.
3. DIMENSIONS ARE IN INCHES[MM].
4. PART INCLUDES:
 - (1) FACEPLATE, SINGLE PORT, WITH SHUTTER
 - (1) RETAINER, FRAME-ADAPTER(SINGLE PORT)
 - (1) SUPPORT, LF80 STRAIGHT TORSION SPRING
 - (1) DOOR, SHUTTERED FACEPLATE
 - (2/14) LABEL, M2000
 - (2/14) RETAINER, M2000 LABEL RETAINER

M11FR-262

COMMSCOPE, INC OF NORTH CAROLINA

| | | | | | | |
|-----|---------|-----|---------------|-------------|-------------------|---------------------|
| 1 | 3/02/16 | | INITIAL ISSUE | AW | DRAWN BY DJ | |
| REV | DATE | ECR | DESCRIPTION | APPROVED BY | DATE 3/02/2016 | DWG NO 760227637 |